

14 TUBINGS

BioService
INDUSTRIAL



Application Range: Cardiosurgery, Haemodialysis, Bloodlines, Infusion Transfusion, Urology, Extension lines, Food Grade

Monolumen tubings \varnothing ext. = 20.0 mm \varnothing int. = 2.0 mm
Hardness: from 56 ShA to 86 ShA / Packaging: Cut - Roll
Material: Soft PVC - PVC NO-DOP - PVC UV Res. - PVC for pump

ETO - Radiation

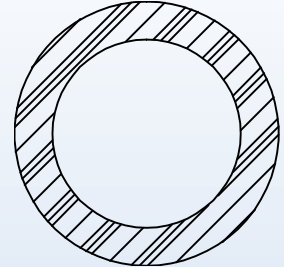

Application Range: Cardiosurgery, Haemodialysis, Bloodlines, Infusion Transfusion, Anaesthesia, Reanimation, Food Grade

Monolumen tubings coextruded color stripe \varnothing ext. = 8.0 mm \varnothing int. = 4.1 mm
Hardness: from 70 ShA to 86 ShA / Packaging: Cut - Roll
Material: Soft PVC / PVC - PVC NO-DOP - PVC USP VI

ETO - Radiation

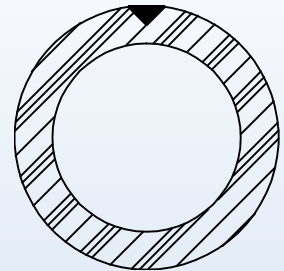

Application Range: Anaesthesia, Reanimation, Urology Extension lines, Food Grade

Monolumen tubings antikinking \varnothing ext. = 10.0 mm \varnothing int. = 5.0 mm
Hardness: from 70 ShA to 86 ShA / Packaging: Cut - Roll
Material: Soft PVC - PVC NO-DOP - PVC USP VI

ETO - Radiation

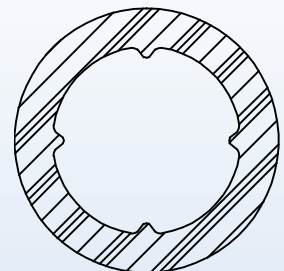

Material PVC _____ PVC No-Dop PE _____ PVC / PE _____

Inside ø (mm): _____

Outside ø (mm): _____

Hardness: _____

Transparent: _____ Frost: _____

Coextruded coloured stripe: _____

Colour stripe: _____

Antikinking: _____

Roll (m): _____

Precut (cm): _____ Cut (cm): _____

Application: (medical device, alimentary, other):

Packaging: _____