

2 FEMALE ADAPTERS

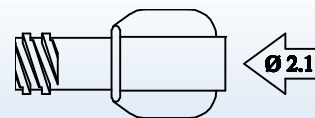

Female luer lock for tube Ø 2.1 mm
Material: Rigid PVC / STD Pack: 15.000 pcs

C11061030 - ETO
C11068010 - Radiation



Female luer lock for tube Ø 2.5 mm
Material: Rigid PVC / STD Pack: 15.000 pcs

C11021030 - ETO
C11028010 - Radiation

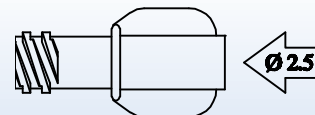

Female luer lock for tube Ø 3.2 mm
Material: Rigid PVC / STD Pack: 15.000 pcs

C11081030 - ETO
C11088010 - Radiation

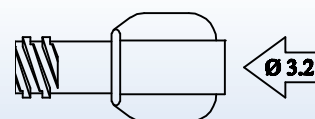

Female luer lock for tube Ø 3.7 mm
Material: Rigid PVC / STD Pack: 15.000 pcs

C11071030 - ETO
C11078010 - Radiation

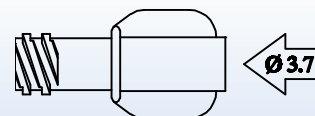

Female luer lock for tube Ø 4.1 mm
Material: Rigid PVC / STD Pack: 15.000 pcs

C11031030 - ETO
C11038010 - Radiation

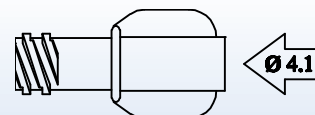

Female luer lock for tube Ø 5.0 mm
Material: Rigid PVC / STD Pack: 15.000 pcs

C11091030 - ETO
C11098010 - Radiation

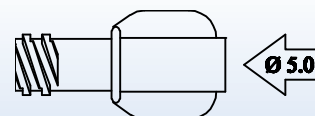

Female luer lock for tube Ø 5.5 mm
Material: Rigid PVC / STD Pack: 15.000 pcs

C11041030 - ETO
C11048010 - Radiation

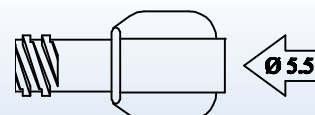

Female luer lock for tube Ø 6.8 mm
Material: Rigid PVC / STD Pack: 15.000 pcs

C21901030 - ETO



Female dialyser connector for tube Ø 6.8 mm
Material: Soft PVC / STD Pack: 4.000 pcs

- C10900030** - ETO - Radiation (Neutral)
- C10900032** - ETO - Radiation (Red)
- C10900033** - ETO - Radiation (Blue)

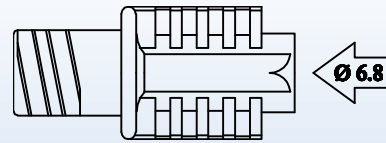

Female dialyser connector for tube Ø 5.5 mm
Material: Soft PVC / STD Pack: 4.000 pcs

- C10910030** - ETO - Radiation (Neutral)
- C10910032** - ETO - Radiation (Red)
- C10910033** - ETO - Radiation (Blue)

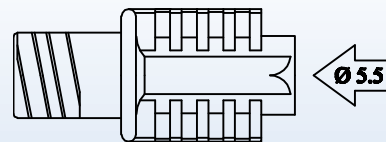

Female dialyser connector for tube Ø 6.8 mm
Material: Semirigid PVC / STD Pack: 4.000 pcs

- C10900150** - ETO (Neutral)
- C10900152** - ETO (Red)
- C10900153** - ETO (Blue)

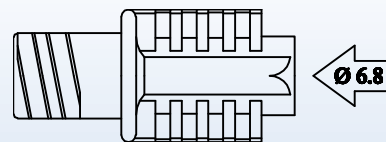

Recirculating adapter with closed vented cap
Material: HDPE / STD Pack: 6.000 pcs

- C11102120** - ETO - Radiation

